

KCI STUDIES MEETING NOTES

PUBLIC MEETING #5

DATE: SEPTEMBER 4, 2008
 TIME: 4:00 TO 7:00 PM
 LOCATION: AMBASSADOR BUILDING, 12200 AMBASSADOR DRIVE

OPEN HOUSE OVERVIEW

The Kansas City Aviation Department, in association with the City Planning and Development Department, hosted the fifth public Open House to present two KCI Airport studies. The studies included the Airport Master Plan Update and KCI Area Land Use Plan. A separate public hearing for the Part 150/Noise Compatibility Study was held in August, so that study was not presented at this meeting. Over 70 community stakeholders were in attendance at the open house held Thursday, September 4, 2008 at the Ambassador Building, 12200 Ambassador Drive from 4:00 to 7:00 PM.

The open house format allowed the public to view each of the project displays and discuss the projects directly with team members. Team members staffed each study area during the entire period to talk individually with citizens about project issues, and to receive their input. Board-mounted graphics displayed summaries of public input and plan options completed to date for both studies.

The meeting concluded at 7:00 PM.

Exhibits were divided by study area into the following station areas: (see floor plan)

1. Airport Master Plan, and
2. Land Use Area Plan

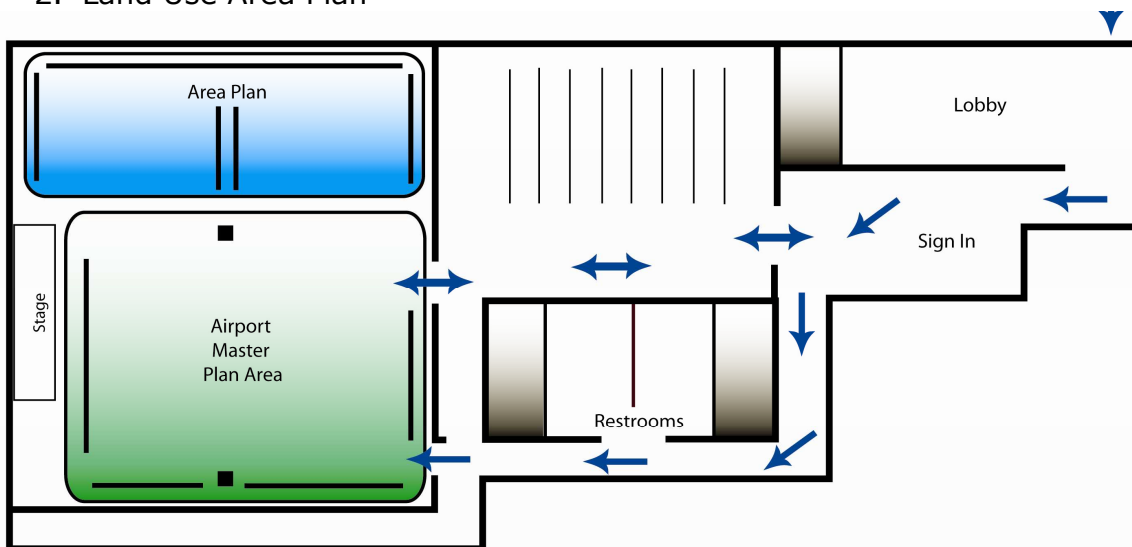

PROJECT OVERVIEW PRESENTATION

A summary presentation was given at 5:00 pm. The presentation included an overview of the project process and the current status of each study.

- KCI Airport Master Plan: terminal development considerations and strategies; short-list terminal development concepts; preferred terminal concept; future airport layout plan; roadway access; and airport land use options for the KCI Airport Master Plan.
- Area Plan Land Use Study: the status of the Area Plan Study, the draft land use plan, priority development zones, transportation framework priorities, urban design framework, stormwater management, and implementation strategies.

VERBATIM COMMENTS: COMMENT CARDS & CORRESPONDENCE

The participants who attended the open house were given the opportunity to share their thoughts with team members. Each participant was given a blank card to provide comments. Of the comment cards received, verbatim responses include:

- **Comment #1:** We own 60 acres at the NW corner of Childress and Barry. I do not understand the buffer designation that covers a great portion of our property on the land use map. We do not agree with what is shown. Please contact me with additional details.
- **Comment #2:** Please build an additional interchange between Highway 152 and Interstate Highway 29 that enables traffic heading eastbound on Hwy 152 west of I-29 to exit onto I-29 heading south, and then exit onto Barry Road. Or allow traffic heading east onto Hwy 152 west of I-29 to exit directly onto Barry Road at I-29.
- **Comment #3:** Again, I question the proposed changes to Hampton Road – moving it to the west. I know it is a low (very) priority, but the proposed road goes through private property. The land use plan should not be cause to create a “public need” for privately held land. The existing road could be maintained or improved without using the land use plan as a “stick” to grab more private land.
- **Comment #4:** The airport plan looks good. I dread its implementation however. I like our airport as is. I’ve lived in several areas of the U.S. and travel frequently and enjoy MCI more than anywhere else. I do understand we need to plan for the future. I’m just glad I won’t be around to travel out of the new facility.

AREA PLAN QUESTIONNAIRE RESULTS

An Area Plan questionnaire handout was provided to all attendees. The questionnaire requested further input regarding the best aspects of the draft plan, any changes that could be made to the plan, and solicited any further comments.

Questionnaire Responses

1. Participants were asked how long they’ve lived in Kansas City, Missouri. (3 responses)

Live in Kansas City Question	Less than 5 years	5-10 years	10-20 years	20 years or more	Don't live in K.C.
How long have you lived in Kansas City, MO?	66%	34%	0%	0%	0%

AREA PLAN QUESTIONNAIRE GENERAL COMMENTS

Participants also had the opportunity to share their comments regarding the Area Plan on their questionnaire. Those verbatim comments are presented here:

Questionnaire Responses

2. What are the best aspects of the draft plan?

- **Comment #1:** Will accommodate a large number of passengers and planes
- **Comment #2:** Will allow a lot of concessions.

3. What three things, if any, would you like to change about the draft plan?

- **Comment #1:** I do not consider shopping and dining a requisite for my air travel experience.
- **Comment #2:** Leaving the 3 pods continues to provide efficient transport and branding by air customers.
- **Comment #3:** Please, consider your community neighbors when planning uses for your airport property.
- **Comment #4:** I am concerned with your new proposed entrance off Hwy 152 and the noise impact on surrounding communities with the increased traffic flow and resulting increase in traffic noise.
- **Comment #5:** Build an additional interchange between Hwy 152 and I-29 to allow traffic heading east on 152 Hwy west of I-29 to exit onto I-29 heading south, and then exit onto Barry Road. Or allow traffic heading east on 152 Hwy west of I-29 to exit directly onto Barry Road at I-29.

4. Do you have any other comments on the draft plan?

- **Comment #1:** We don’t need more concessions because we don’t have to get to the airport hours in advance to get through security.
- **Comment #2:** Why not redo the parking and add onto the inner circle instead of completely relocating.
- **Comment #3:** Sounds like you won’t have any more gates?

- **Comment #4:** I like the plan as shown, but am glad I won't be flying by the time it all comes about.
- **Comment #5:** Aircraft noise is a consideration to me as a neighboring community. Please be mindful of your noise impact on surrounding communities when you prepare runway expansion.

AREA PLAN PARTICIPANT ORAL DISCUSSION

The participants who attended the open house were given the opportunity to share their thoughts with team members. Oral discussion captured during the Area Plan exercise included:

- **Comment #1:** The study area needs more "leisure" activities. All there is are businesses and nothing for people flying in to do without driving.
- **Comment #2:** Does the stream buffer preclude all development?
- **Comment #3:** When will the Line Creek Area Plan be completed?
- **Comment #4:** I don't believe you should put any residential south of the airport due to the noise impacts. People will call and complain.
- **Comment #5:** Good exhibits – they are clear and colorful.
- **Comment #6:** When designing bike lanes, make sure they are done properly – unlike the bike lanes at Zona Rosa. They are dangerous.
- **Comment #7:** What is going to be acquired to protect the noise contours? I am concerned with noise and acquisitions.
- **Comment #8:** We are concerned with the noise from the racetrack. We live west of I-435 and we don't like the racetrack. We think the airport should have asked us before they put it in.
- **Comment #9:** We have a house off Tiffany Springs Road and 68 acres. Our son wants to build another house on it. Are we allowed to do that?
- **Comment #10:** I am against residential development around the airport. Everyone within a 10-mile radius of the airport should have to sign a statement saying they won't sue the airport about noise.